

PLAN
(SM TYPE KERB)

REINFORCEMENT DETAILS	REINFORCEMENT
PIT DEPTH "D"	
UP TO 1.700	NIL
OVER 1.700	F92

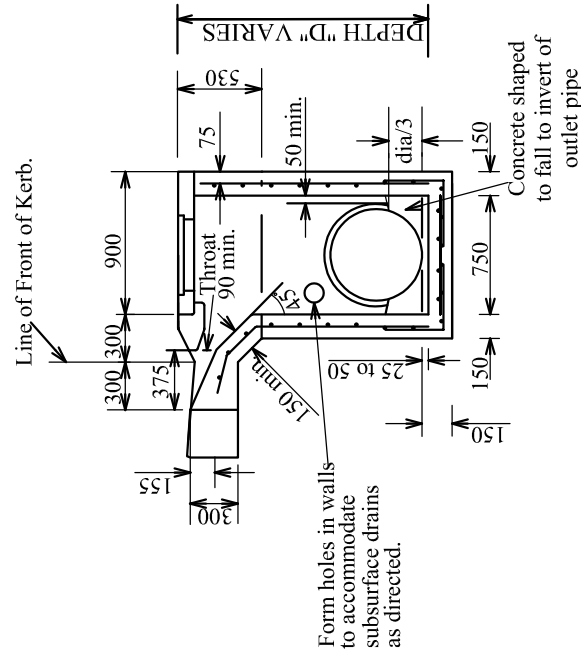

SECTION B-B
PIT TYPE 1
(SM TYPE KERB)

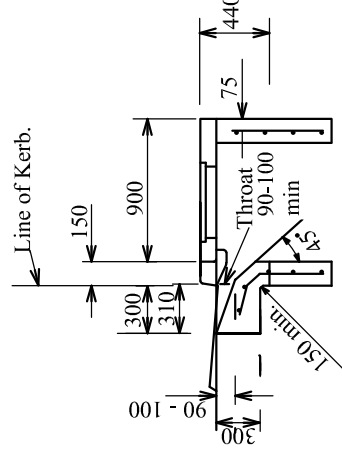

SECTION B-B
PIT TYPE 2
(B TYPE KERB)

NOTES:

1. HAUNCHING MAY BE REQUIRED FOR PIPES OVER 450mm dia. REFER TO PIT SCHEDULE FOR SIZES OF SPECIFIC PITS.
2. PITS WITH HAUNCHING IN TWO DIRECTIONS REQUIRE SPECIAL STRUCTURAL DESIGN
3. PITS DEEPER THAN 1m SHALL BE FITTED WITH STEP IRONS. REFER TO SD1001
3. IF FINAL PAVEMENT LAYERS ARE DEFERRED, PROVISIONS SHALL BE MADE TO PREVENT WATER FROM ENTERING THE PIT
4. PRECAST PITS WITH THINNER WALLS AND LESS STEEL MAY BE ACCEPTED WHERE THE MANUFACTURER CAN DEMONSTRATE THAT THE PITS HAVE ADEQUATE CAPACITY TO SUPPORT A COMBINATION OF THE FOLLOWING LOADS
 - LATERAL LOADS - EARTH PRESSURE WITH 210kN SURCHARGE
 - HYDROSTATIC PRESSURE
 - COMPACTION PRESSURE 25kPa (min)
5. VERTICAL LOADS - 210kN
5. COVERS AND LINTELS ARE REQUIRED TO SUPPORT A TEST LOAD OF 100kN WITHOUT PERMANENT DEFORMATION OR DAMAGE. IN AREAS SUBJECT TO TRUCK LOADING, HEAVY DUTY COVERS (210kN) ARE TO BE INSTALLED.
6. STANDARD SIDE ENTRY PIT INTERNAL DIMENSIONS TO BE 750mm WIDE 900mm LENGTH

